





-  superficie coperta
-  superficie scoperta
-  superficie coperta - permesso di costruire anno 1924
-  superficie coperta - planimetria catastale anno 1940
-  superficie coperta - D.I.A. anno 2010



Via Premuda

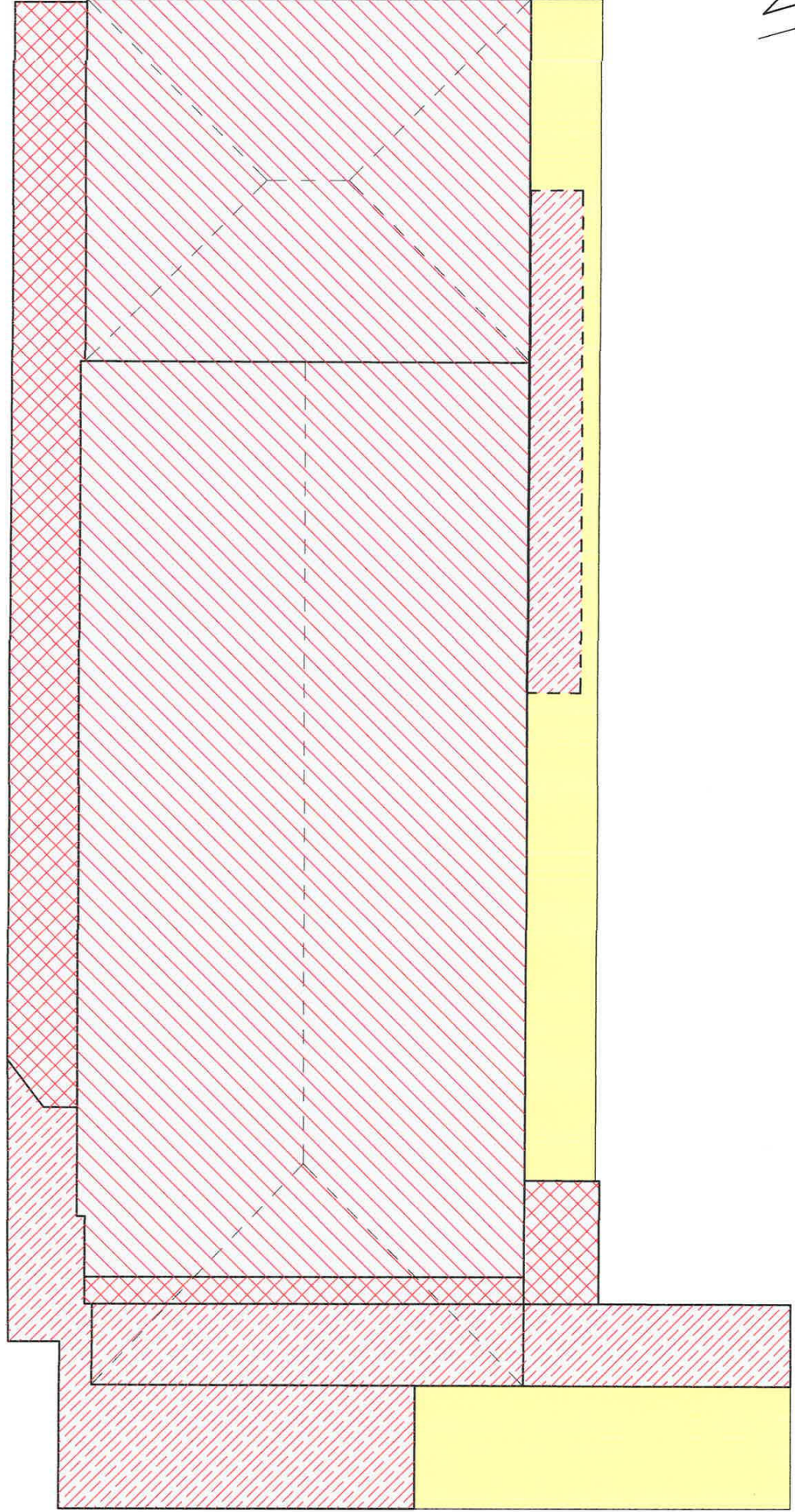
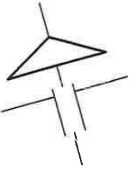

TRIBUNALE ORDINARIO DI VENEZIA - E.I. 142/2018	
Esperto stimatore: Arch. LAURA GHEZZI	
LOTTO UNICO	TAV. 3
PLANIMETRIA GENERALE SUPERFICI	Scala 1:100
Comune di Venezia Via Premuda nn. 12-14-16	

- superficie coperta
- superficie scoperta

